



Making your products move

Container Centralen Ltd

Information Pack

**Container Centralen Limited, Suites 7& 8 Ground Floor,
Hawley Manor, Hawley Rd, Dartford Kent, DA1 1PX**

Tel: +44 (0)1322 294267 Fax: +44 (0)1322 225290

e-mail: ccuk@container-centralen.com

Website www.container-centralen.com

Registered Office: **as above.** Registered in England No. 4344379



Making your products move

WELCOME TO CONTAINER CENTRALEN

Thank you for opting to be a part of a marvellous logistic concept enabling your company to move your goods efficiently and more cost effectively utilising our unique trolley system.

Container Centralen is a Danish Company specialising in the movement / logistics of primarily horticultural products.

Our head office is based in Denmark, although our associate companies are based here in the UK, Germany, Norway, Italy, Spain, Poland, Czech Republic, France, Holland and U.S.A.

On the following pages we hope that you will find some useful information regarding our company.

Page 3.	The CC System
Page 4.	Working Practice Information
Page 5.	Regional Location of our Depots
Page 6.	Depot Addresses and Contact Information
Page 7.	CC Products & Services
Page 8.	Depot Stacking / Handling requirements
Page 9.	Padlock Poster – What should you be looking for?
Page 10.	Information Required from New Customer





Making your products move

THE CC SYSTEM – OPTIONS AVAILABLE TO YOU

We are always happy to submit a quote to enable you to see which cost effective option is best for your company needs.

Long Term Hire

Initially you pay a once only upfront rental figure and a service fee covering the first year only. After this initial cost you will be invoiced on a yearly basis for a Repair and Maintenance Pool Fee.

Pool Fee

The concept is that broken items will be swapped for good usable stock so that you are not inconvenienced in the day to day running of your business. Transportation to pick up repairs is an additional service. The fee, which is charged annually, covers the cost of repair only at one of our regional depots. Some of our depots also operate independent transport companies. We can give you their contact numbers to enable you to obtain a quote directly from them.

Day Hire / One Year Hire

If you need additional stock for a short period during your busiest time, then this may be an option to consider. Prices will fluctuate depending on the time of year and which month you wish to hire the stock in – **Low or High Season**. Payment is required prior to the release of the stock. Day Hire and One Year Hire are only available to existing Long Term Hire customers.

Day hire is for a minimum of 30 days. A refundable equipment deposit is required prior to the stock being released. Thereafter you will be invoiced on a monthly basis until the stock is returned to a depot.

We are now also offering many logistic services which you may find of interest to your company. Please contact us to obtain further information / fact sheets or alternative visit our website :- www.container-centralen.com





Making your products move

WORKING PRACTICES AND GENERAL INFORMATION **POINTS TO REMEMBER**

YOUR CLIENT NUMBER

This will be found on your covering letter and contract.

All UK customers will start with **60xxxx** and all Irish customers will start with **70xxxx**.

Please remember to quote this number on

- ❖ All correspondence
- ❖ Payments made
- ❖ Fax requests regarding exchanges / repairs

REMEMBER YOUR INVOICE NUMBER

It is imperative that all cheques sent in settlement of an invoice show this number on the reverse. It is also useful if this number is quoted on any correspondence regarding payment matters e.g. UK010.....

EASIER WAY TO PAY - B A C S

- ❖ Faster way to paying through your bank
- ❖ More efficient and reliable
- ❖ Cost effective

Our Account Name is: CONTAINER CENTRALEN LTD

Our Account Number is: 51390481

Sort Code: 40 20 25

Bankers: HSBC – DARTFORD KENT

Please ensure that a remittance advice is sent to us prior to payment advising us of the transaction date and once again quoting your invoice and client number.

DIRECT DEBIT

An alternative way to pay the annual pool fee is to pay by Direct Debit. We strongly urge you take up this option to avoid reminder letters having to be sent out to you. It is very simple to set up all you have to do is complete the mandate with all your bank details and return this to us. We will do the rest and update your records in our system.

EXCHANGE OF BROKEN ITEMS

- ❖ Telephone / Fax / Email to be sent to the CC Ltd office detailing:
 - a) Quantities
 - b) Depot Preferences
- ❖ Confirmation Details faxed / emailed to yourselves and the Depot to enable you to contact depot directly to arrange an actual date and time.
- ❖ Information sheet regarding stacking details etc faxed to you for the relevant depot.
- ❖ Please ensure that the receipt is signed by both the driver and the depot representative when the stock is returned to the depot.



Making your products move

DEPOT LOCATIONS



Scotland

Argyll
Lanarkshire

Corachie
Reynard
(Sub Depot)

Argyll
Wishaw

Ireland

Co Kildare

James Roche

Naas

Mainland UK

Cheshire

Flower & Plant
Logistics

Knutsford

Southampton

Forest Transport

Marchwood

Gloucestershire

R.A.Meredith

Saul

Cambridgeshire

Jasmine Nursery
(Sub Depot)

Cambridge

Bedfordshire

Andersons

Moggerhanger

Worcestershire

Rick White Ltd

Pershore

Somerset

Greenfields Nursery
(Sub Depot)

Wellington

Norfolk

Foulger Transport

Norwich

N.B Sub depots hold only a limited amount of stock and are mainly used for when exchanging broken stock.

ALL CUSTOMERS CAN EXCHANGE CC CONTAINERS AND PARTS AT ANY OF THE ABOVE DEOPTS. PLEASE ENSURE THAT SIGNED PROOF OF DELIVERY / COLLECTION IS OBTAINED



Making your products move

Depot Addresses and Contact Information

Depot Location	Name	Address	Contact Name	Tel Number	Fax Number
Argyll	Corachie Clematis	Corachie Cottage, Taynuilt, Argyll PA35 1HY	Douglas Baird	01866 822266	01866 822570
Gloucs.	R.A Meredith & Sons Nurseries	Fretherne Nurseries Saul, Gloucestershire GL2 7JF	Gary Counsell	01452 741278	01452 741778
Hampshire	Forest Transport Services	Area B3 Central Industrial Cresnet, Marchwood Ind Park, Hampshire Southampton SO40 4BJ	Sue Rowe	023 80894484	023 80894484
Ireland	DC Transport	Allenwood Middle Naas Co Kildare Ireland	James Roche	00353 45870212	00353 45870931
Cambridgeshire	Jasmine Nursery	Sub Depot – Limited stock held Please contact - CCUK			
Lanarkshire	Reynard Nursery	Sub Depot – Limited stock held Please contact Corachie Clematis	Douglas Baird		
Worcestershire	Rick White Ltd	Racecourse Industrial Estate, Cobham Road, Pershore, Worcestershire WR10 2DL	Lee Davies	01386 552200	01386 556587
Bedfordshire	Andersons	White Gables, Blunham Road, Moggerhanger, Beds MK44 3RA	Julie / Jamie	01767 642404	01767 641408
Cheshire	Flower & Plant Logistics	Stocks Lane, Over Peover, Knutsford, Cheshire, WA16 9EZ	Dave Rutter	07756 807006	Tel / Fax 01477 534686
Somerset	Greenfields Nursery	Sub Depot – Limited stock held	Mark Stewart	01823 662462	01823 652352
Norfolk	Foulger Transport	Harling Road, Snetterton, Norwich Norfolk, NR16 2JU	Tom Baron	01953 715505	01953 888233

ALL OF OUR DEPOTS HAVE SEASONAL VARIANCES OF OPENING HOURS, SO PLEASE CONTACT THE DEPOT DIRECTLY TO COMFIRM THE BOOKING OF YOUR VEHICLE, ONCE YOU HAVE CONTACTED THE CC OFFICE TO OBTAIN A WORKSHEET. ALL DEPOTS ARE ABLE TO EXCHANGE BROKEN STOCK.



Making your products move

Products:



CC Container – the European flower & pot plant trolley



CC 1/2 Container – the 1/2 size European flower & pot plant trolley



CC Eurocontainer - the flower & plant display trolley



CC Rollcontainer - the two-sided roll cage



CC Freshbox – the returnable plastic crate



CC Eurocrate – the collapsible crate



CC Minitainer - the sturdy roll cage



CC Eurodolly - the RFID-tagged rolling quarter pallet



CC Dolly – the rolling quarter pallet



CC Rolly - the rolling half pallet

Services:

CC Hire Services

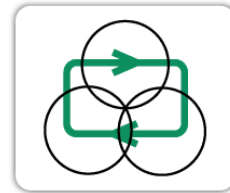

We offer hire services for every need

CC Depot Services

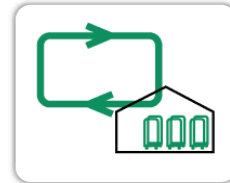

Extra services for your RTIs

CC Transfer Service

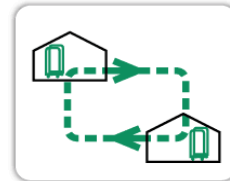

We hand out your RTIs where you need them

CC One-Way Service



You ship – we take care of the rest

CC LogLink Service

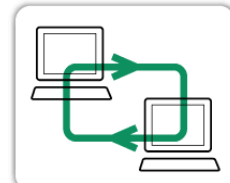

We show your RTIs' every move

CC Collection Service

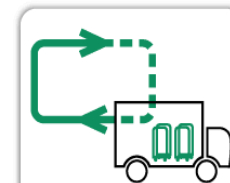

We take care of your return-flow

CC Balance Service

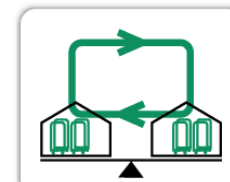

We keep track of your RTI balances



Making your products move

Recommended stacking for the return of empty CC Trolleys



Total stack weight 342Kg



Total stack weight 230Kg

Bases

Bases should be stacked **10** high with **4** posts between each base.

8 posts should be placed on the bottom base with none on the top base. For additional safety all posts should protrude from the base at one end only.

All bases should face the same direction. All CC plates and padlocks should be visible from one end for easy recognition.

Shelves

Shelves should be stacked in **30's**.

Each post has **30** holes, this facilitates easy counting if all the holes are filled.

Weights

Base: 20.4kg

Shelf: 6.5kg

Post: 3.45kg

Dimensions

Length: 1350 mm

Width: 565 mm

Height: 1900 mm



Making your products move

Padlock Poster – What should you be looking for?



OK FOR REPAIR AND EXCHANGE AND USE WITHIN THE CC SYSTEM



DO NOT USE



DO NOT USE



DO NOT USE



DO NOT USE – These padlocks are not part of the CC Pool system. The current CC padlocks have a distinctive yellow label.



Making your products move

INFORMATION REQUIRED FOR UK / IRISH CUSTOMERS

Company Name:	
Name that Contract is to be Issued in if different to the above: (Registered company name)	
Contact Details	Telephone:
	Fax:
	Email:
Contact Names: (Including Company Director / Partners)	
Company Registered Address:	
Delivery Address: (If different from Above)	
Company Registration Number:	
V.A.T Number:	

Signature.....

Print Name.....

**Container Centralen Limited, Suites 7 & 8 Ground Floor,
Hawley Manor, Hawley Rd, Dartford, Kent, DA1 1PX**
Tel: +44 (0)1322 294267 Fax: +44 (0)1322 225290
e-mail: ccuk@container-centralen.com
Registered Office: **as above. Registered** in England No. 4344379
VAT: GB 802372755